

The Slimstile Range

MODEL DT-1

These turnstile combine aesthetic appeal with positive access control.



Simplex Model

- ! *Sturdy structure*
- ! *Strong mechanism*
- ! *Built-in fool proof logic control*
- ! *Open interface with Access controllers*
- ! *Unidirectional / Bi-directional*
- ! *Fail safe Lock / Unlock*
- ! *Attractive design/Models*
- ! *Easy Maintenance*

The TURNSTILE is an electrically controlled access authentication system which accepts various input signals to restrict unauthorised entry.

The signals can be fed from any access control system such as electronic card reader system, finger scan system etc., through their relay outputs or from local & remote switch signals.

The TURNSTILE allows only the authorised persons to enter the restricted areas providing the total physical control necessary to compliment manned entry position. It can be utilised to allow flow of entry, exit, or both. The whole system of TURNSTILE ensures the important concept of "One Time One Pass", with the tremendous benefit of Security and Security check detections.

APPLICATIONS :

- 6 Defence establishments
- 6 R&D establishments
- 6 Nuclear & Missile test beds.
- 6 Railways
- 6 Fun Parks
- 6 VIP areas.
- 6 Telephone exchanges
- 6 Power Plants
- 6 Parliament & Assembly House
- 6 Office premises
- 6 Stadiums and Playgrounds
- and many more

DIMENSIONS & TECHNICAL SPECIFICATION

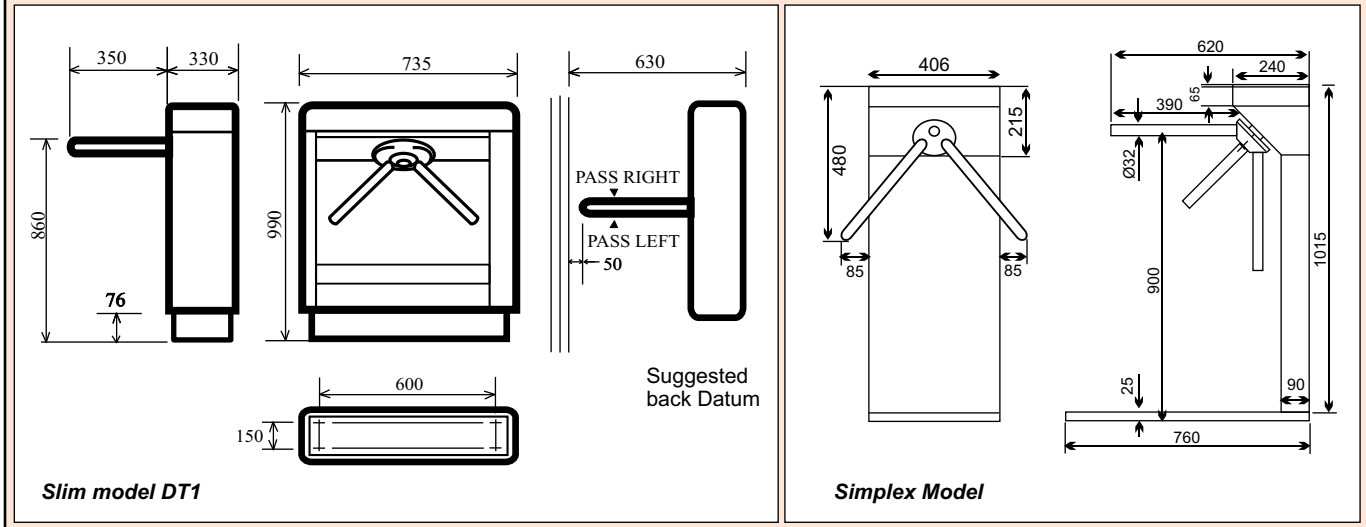

The turnstile is available in various configurations to allow control of entry or both. Normally passage is to the left of the casework when individual units are used for entry or exit, but where space is limited, or the flow rates low the casework can be bidirectional with the tripod head mechanism accepting a signal from either direction.

The Turnstile can be arranged to open from a variety of local or remote input signals, such as coin mechanisms, security control room etc. Security card readers can be fixed to the ends of the cabinets to form an effective controls barrier.

The cabinet is constructed of heavy-gauge mild steel with epoxy powder coated finish or stainless steel ensuring long trouble free operating life and requiring minimal maintainance.

The Tripod barrier arms are recessed into the cabinet ensuring that there are no obstructions to impede passage or sharp ends to catch clothing.

The tripod barrier design utilises a positive action lock which prevents two passes at one time. A self centering mechanism with hydraulic damping ensures complete rotation of the tripod head to the reset position.

An anti back-up device prevents reverse rotation once the tripod head has moved 25° from rest.

INSTALLATION

Installation is simple matter of first bolting to the floor a 76mm deep plinth of heavy section steel. The cabinet is then bolted to the plinth through 4 holes within the body base, thus facilitating a level mounting.

SPECIFICATIONS :

Frame	: SS or MS powder coated
Gate open time	: 2 to 10 Secs. user selectable.
Direction	: Uni / Bi-directional user programmable.
Mechanism	: Strong & rugged, Tie-Bar, Linkage Free Self centering with Hydraulic damper
Anti pass back	: prevents reverse rotation once Rotor moved 25° from rest.
Configure	: Fail safe / Fail lock
Control Command	: Potential free (N.O.), 5-12 V signal
Indicator	: Red / Green Lamps for access.
Options	: 12V, 6 AH Battery operation in case of power failure Arco pass barrier (Lane Guide) six-digit-non-resettable -tamper proof counter
Power	: 115V / 60Hz or 240V / 50 Hz, 150 W,
Temp	: -5°C to 55° C
Humidity	: 95% non condensing.
Total weight	: 83Kg. (The cabinet weights 71Kg. and the plinth 12Kg.)
Models	: Slim, Simplex and Sentinel

Specifications are subject to change without notice